



**Pumps & Injectors for AdBlue®**  
For direct replacement of OE parts

going the extra mile



Your Partner in Exhaust and Emission

## We are proud to announce the extension of DinTronic range by adding injectors and pumps for AdBlue® as the next step to keep your ATS system healthy.

We have noticed that in many cases problems with the ATS system are caused by a faulty injection system for AdBlue®. This further leads to crystallization of AdBlue®, SCR blockage, NOx sensor failure etc. It is much more cost effective to maintain the injection system for AdBlue® and avoid expensive ATS system repairs.

## DinTronic, Injectors for AdBlue®

### Our Injectors for AdBlue® are:

- Directly replaceable with OE injectors
- Tested at Dinex test center
- Stock item for fast delivery
- A cost effective balance between emission control and Urea consumption

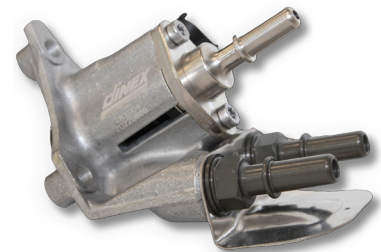

Make	Model	Vehicle	Norm	OE no.	Dinex no.
DAF	CF75 / CF85 / CF105	Truck	Euro 6	1819790, 1791538, 1674654,1791539	<a href="#">2AT000</a>
DAF	CF86 / XF106	Truck	Euro 6	1819798	<a href="#">2AT002</a>
DAF	CF75/CF85/XF105	Truck	Euro 5	1674662, 1735780, 1735780, 1674662/0444012003	<a href="#">2AT014</a> <b>NEW 2025</b>
Iveco	Stralis / Trakker	Truck	Euro 5	504365576	<a href="#">2KT000</a> <b>NEW 2025</b>
Iveco	Eurocargo / Stralis / Trakker	Truck	Euro 5	504374327, 5801730656	<a href="#">2KT001</a> <b>NEW 2025</b>
Iveco	Citelis / Evadys / Arway / Crossway / Crealis / Eurorider / Magelys / Domino	Bus	Euro 6	5801392767	<a href="#">2KT002</a>
Iveco	Truck-Stralis / Trakker / Crossway/ Urbanway	Truck / Bus	Euro 6	5801506959	<a href="#">2KT004</a> <b>NEW 2025</b>
Ford	F-MAX	Truck	Euro 6	GC465J281BA, T224029	<a href="#">2MT000</a>
MAN	TGA/TGX/TGS	Truck	Euro 6	51.15403.6000, 51.15403.6001, 51.15403.6003	<a href="#">4IT003</a>
Mercedes	Actros	Truck	Euro 6	000.140.5339, 000.140.5439, 000.140.3939, 000.140.7139	<a href="#">5AT000</a>
Scania	Truck-P / G / R / S / T BUS- F / K / N	Truck / Bus	Euro 6	2238325, 2238324, 2722701, 2095566	<a href="#">6LT000</a>
Scania	Truck-P / G / R / T / F / K / N	Truck / Bus	Euro 6	2001791, 1753208	<a href="#">6LT001</a>
Volvo	FH / FM	Truck	Euro 6	21644763, 21574984	<a href="#">8AT001</a>
Volvo/Renault	Volvo-FE / FL Renault-C / D Narrow / D Wide	Truck	Euro 6	21679307, 22588556, 7422588556, 7421679307	<a href="#">8AT005</a>
Volvo/Renault	Volvo- FH / FM Renault- C / K / T	Truck	Euro 6	23241772, 7423241772, 7422588468, 7421679303	<a href="#">8AT006</a> <b>NEW 2025</b>
Volvo/Renault	FL / FE	Truck	Euro 5	21234237, 21738116	<a href="#">8AT032</a> <b>NEW 2025</b>
Volvo/Renault	B7R / R7 / R7LE	Truck	Euro 6	20908923, 20776520	<a href="#">8AT033</a>

# DinTronic, Pumps for AdBlue®



## Our Pumps for AdBlue® are:

- Directly replaceable with OE pumps
- Tested at Dinex test center
- Stock item for fast delivery
- A cost effective balance between emission control and Urea consumption

Make	Model	Vehicle	Norm	OE no.	Dinex no.
DAF	CF / XF106	Truck	Euro 6	1819797, 2871880, 2880158, 4387658, 4387658, 444606536	<a href="#">2AP002</a>
DAF/Dennis/ ADL	CF65 / LF45 / LF55	Truck / Bus	Euro 6	1409391, 1705244, 1612308, 1138505, 4931694, 5273338	<a href="#">2AP003</a>
Iveco	Stralis	Truck	Euro 6	504381868, 5802513619, 5802855457	<a href="#">2KP000</a>
Iveco	Truck-Stralis BUS-Crossway / Evadys	Truck / Bus	Euro 5	41271148	<a href="#">2KT008</a>
Ford	F-MAX	Truck	Euro 6	GC465H297AA, T218810, T419665	<a href="#">2MP000</a> <b>NEW 2025</b>
Mercedes	Actros / Arocs	Truck	Euro 6	000.140.5678, 000.140.7278, 000.140.7978	<a href="#">5AP001</a>
Mercedes	Atego / Axor / Actros	Truck	Euro 6	000.140.0978, 000.140.1578, 000.140.0078, 000.140.0178, 000.140.0278, 000.140.0378, 000.140.0478, 000.140.0578, 000.140.2578, 000.140.4478	<a href="#">5AP005</a>
Mercedes	Truck-Axor / Actros / Antos / BUS-Citaro	Truck / Bus	Euro 6	000.140.0239, 000.140.0539, 000.140.0739, 000.140.4139	<a href="#">5AU000</a>
Scania	Truck-P / G / R / S / F / K / N	Truck / Bus	Euro 6	2057543, 2182737, 1915357, 2009872, 2695808	<a href="#">6LP001</a>
Volvo	FH / FM	Truck	Euro 6	22851845, 21574975	<a href="#">8AP000</a>
Volvo	Truck FH / FM / BUS B13R / B8R	Truck / Bus	Euro 6	21576178, 21335892	<a href="#">8AP001</a>

## Other AdBlue® Components

**NEW 2025**

Make	Model	Vehicle	Type	Norm	OE no.	Dinex no.
Iveco	Truck-Stralis Bus-Crossway/Evadys	Truck / Bus	AdBlue® doser	Euro 5	41271148	<a href="#">2KT008</a>
Mercedes	Actros/Arocs	Truck	AdBlue® doser	Euro 6	000.140.5678, 000.140.7278, 000.140.7978	<a href="#">5AP001</a>
Mercedes	Truck-Axor/Actros/Antos Bus-Citaro	Truck / Bus	AdBlue® dosing module	Euro 6	000.140.0239, 000.140.0539, 000.140.0739, 000.140.4139, 000.140.2039	<a href="#">5AU000</a>
Mercedes	Truck- Actros / Atego / Axor / Antos / Arocs BUS- Tourino / Citaro / Connecto / Travego / Tourismo / Integro / Intouro / Vario	Truck / Bus	AdBlue® diffuser heater	Euro 6	000.140.0030	<a href="#">5AU001</a>
Mercedes	Truck- Actros / Atego / Axor / Antos / Arocs BUS- Tourino / Citaro / Connecto / Travego / Tourismo / Integro / Intouro / Vario	Truck / Bus	AdBlue® pressure sensor	Euro 6	0061537528	<a href="#">51056</a>
Mercedes	Truck- Actros / Atego / Axor / Antos / Arocs BUS- Tourino / Citaro / Connecto / Travego / Tourismo / Integro / Intouro / Vario	Truck / Bus	AdBlue® pressure sensor	Euro 6	0061537428	<a href="#">51057</a>
Mercedes	Truck- Actros / Atego / Axor / Antos / Arocs BUS- Tourino / Citaro / Connecto / Travego / Tourismo / Integro / Intouro / Vario	Truck / Bus	Urea temperature sensor	Euro 6	0061534528	<a href="#">51089</a>
Scania	Truck- P / G / R / T BUS-F / K / N	Truck / Bus	High pressure pipe	Euro 6	1939987	<a href="#">6LL037</a>

## Diesel exhaust aftertreatment system for heavy duty Euro VI engines

